

# I sprat

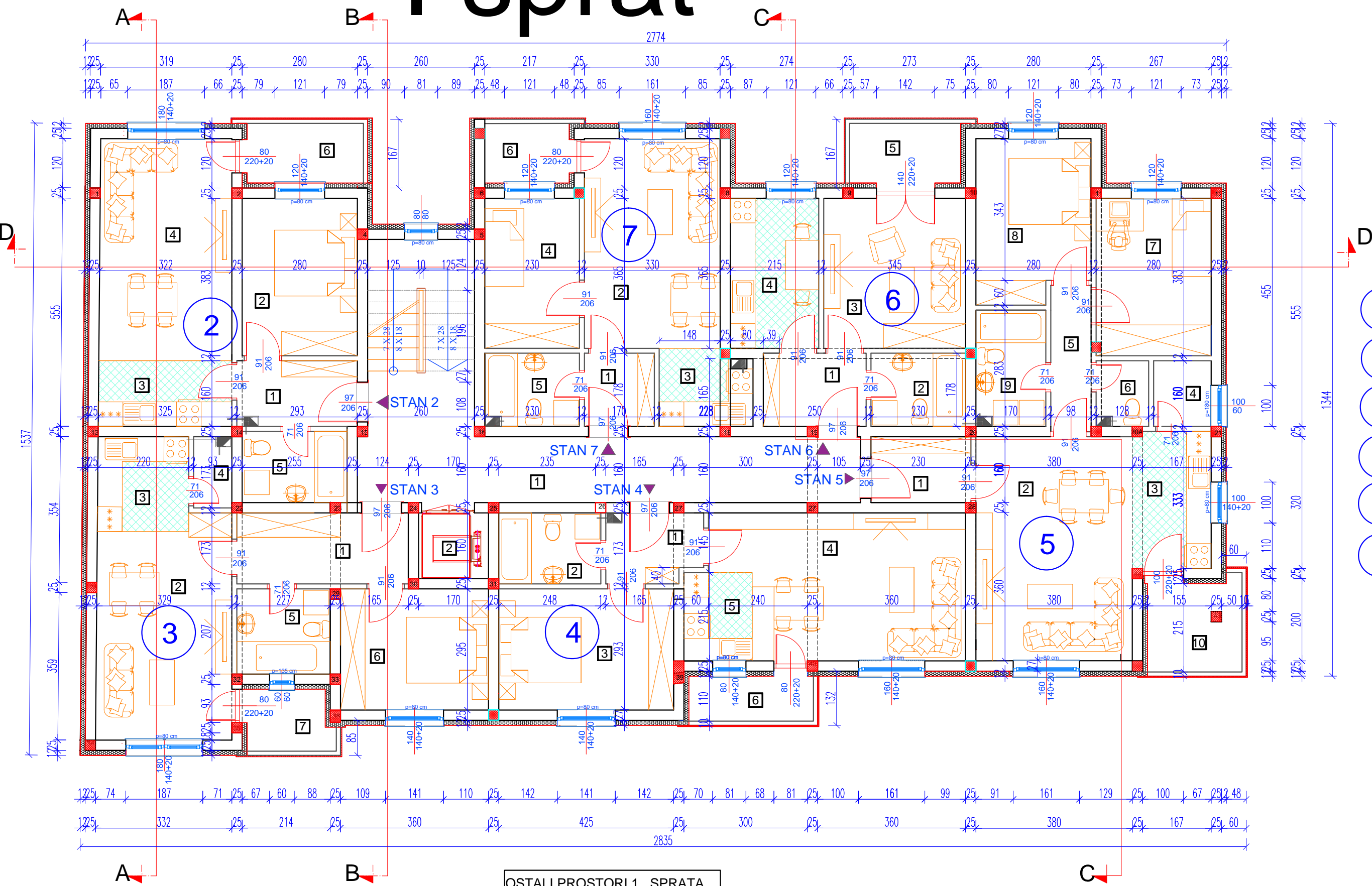

stanovi:

- ② 45,09 m<sup>2</sup>
- ③ 47,94 m<sup>2</sup>
- ④ 46,37 m<sup>2</sup>
- ⑤ 67,77 m<sup>2</sup>
- ⑥ 32,02 m<sup>2</sup>
- ⑦ 38,15 m<sup>2</sup>

OSTALI PROSTORI 1. SPRATA				
	NAZIV PROSTORIJE	VRSTA PODA	OBIM	POVRŠINA
①	HODNIK SA STEPENIŠTEM	granitna ker.	37.28 m	32.06 m <sup>2</sup>
②	LIFT	beton	6.60 m	2.72 m <sup>2</sup>
			ukupno P =	34.78m <sup>2</sup>

NETO 1. SPRATA 312.12m<sup>2</sup>

BRUTO 1.SPRATA 388.32m<sup>2</sup>